



2 Gilston Mews, Gilston Park, Gilston, CM20 2RG

Asking Price: £750,000
Freehold

www.intercounty.co.uk



Intercounty
Estate and Letting Agents



A well-presented family home nestled within the popular Gilston Park development. The property offers a generous amount of accommodation arranged over three floors.

The accommodation comprises an entrance hall, large lounge, kitchen and breakfast room, separate formal dining room, utility, conservatory and a ground floor cloakroom. On the first floor there are three generous bedrooms and a family bathroom, whilst on the second floor is a large principal bedroom with an ensuite. To the front of the property, there is parking for three cars and a stable, which is currently being used for storage. To the rear is a large, secluded garden, mainly laid to lawn with a decked area ideal for entertaining.

Council Tax Band E. EPC Rating D.



Large Period Family Home
4 Generous Bedrooms
2 Bath/Shower Rooms
3 Receptions
Large Rear Garden
Driveway Parking
Council Tax Band E
EPC Rating D

ADDITIONAL INFORMATION

Gilston is a village in East Hertfordshire surrounded by rolling countryside with open fields and woodland, with its own village Inn. The village is located with easy access to M11 and mainline train services into London. The market towns of Hertford, Ware and Bishop's Stortford are within a convenient drive, all of which offer further shopping, schooling, and recreational amenities.

Gilston Mews, Gilston Park, Gilston, Harlow, CM20

Approximate Area = 2184 sq ft / 202.9 sq m
 Limited Use Area(s) = 106 sq ft / 9.8 sq m
 Outbuilding(s) = 454 sq ft / 42.2 sq m
 Total = 2744 sq ft / 254.9 sq m
 For identification only - Not to scale

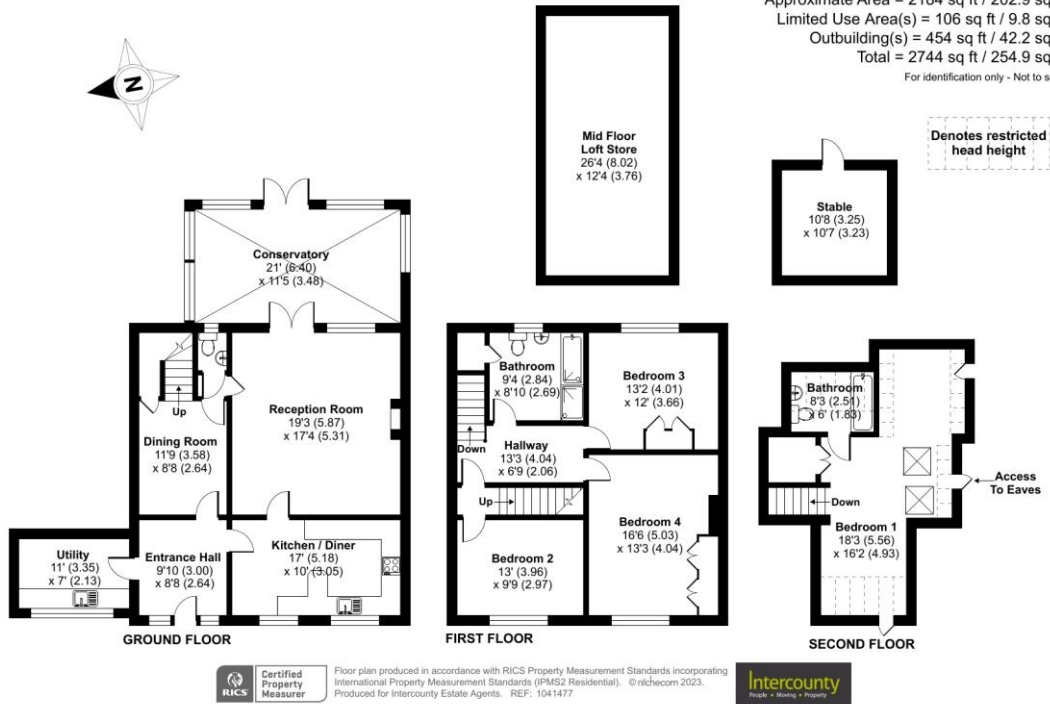

- Entrance Hall** 9'10" x 8'8" (3m x 2.64m)
- Utility Room** 11' x 7' (3.35m x 2.13m)
- Kitchen/Diner** 17' x 10' (5.18m x 3.05m)
- Dining Room** 11'9" x 8'8" (3.58m x 2.64m)
- Reception Room** 19'3" x 17'4" (5.87m x 5.28m)
- Conservatory** 21' x 11'5" (6.4m x 3.48m)
- First Floor**
- Bedroom 2** 13' x 9'9" (3.96m x 2.97m)
- Bedroom 3** 13'2" x 12' (4.01m x 3.66m)
- Bedroom 4** 16'6" x 13'3" (5.03m x 4.04m)
- Bathroom** 9'4" x 8'10" (2.84m x 2.7m)
- Top Floor**
- Bedroom 1** 18'3" x 16'2" (5.56m x 4.93m)
- Ensuite** 8'3" x 6' (2.51m x 1.83m)

AGENTS NOTES IMPORTANT NOTE TO PURCHASERS: We endeavour to make our sales particulars accurate and reliable, however, they do not constitute or form part of any offer or any contract and none is to be relied upon as statements of representation or fact. The services, systems and appliances listed in this specification have not been tested by us and no guarantee as to their operating ability or efficiency is given. All measurements have been taken as a guide to prospective buyers only and are not precise. Floorplans where included are not to scale and accuracy is not guaranteed. If you require clarification or further information on any points please contact us, especially if you are travelling some distance to view. Fixtures and fittings other than those mentioned are to be agreed with the seller. We may refer you to recommended providers of ancillary services such as Conveyancing, Financial Services, Insurance and Surveying. We may receive a commission payment fee or other benefit (known as a referral fee) for recommending their service. You are not under any obligation to use the services of the recommended provider. The ancillary service provider may be an associated company of Intercounty.

ANTI-MONEY LAUNDERING We are required by law to conduct anti-money laundering checks on all those selling or buying a property. Whilst we retain responsibility for ensuring checks are carried out correctly and for ongoing monitoring, the initial checks are carried out on our behalf by Lifetime Legal who will contact you once you have agreed to instruct us in your sale or had an offer accepted on a property you wish to buy. The cost of these checks is £60 inc VAT, which covers the cost of obtaining relevant data and any manual checks and monitoring which might be required. This fee is paid in advance, directly to Lifetime Legal and is non-refundable.

FOR MORE DETAILS CONTACT

1 Bell Street, Sawbridgeworth, Hertfordshire, CM21 9AR

T: 01279 600333 | W: www.intercounty.co.uk

Intercounty
 Estate and Letting Agents